

Porteos

MOTORCYCLE & UNIVERSAL LOADERS

INSTALLATION GUIDE AC 001 inside frame extender

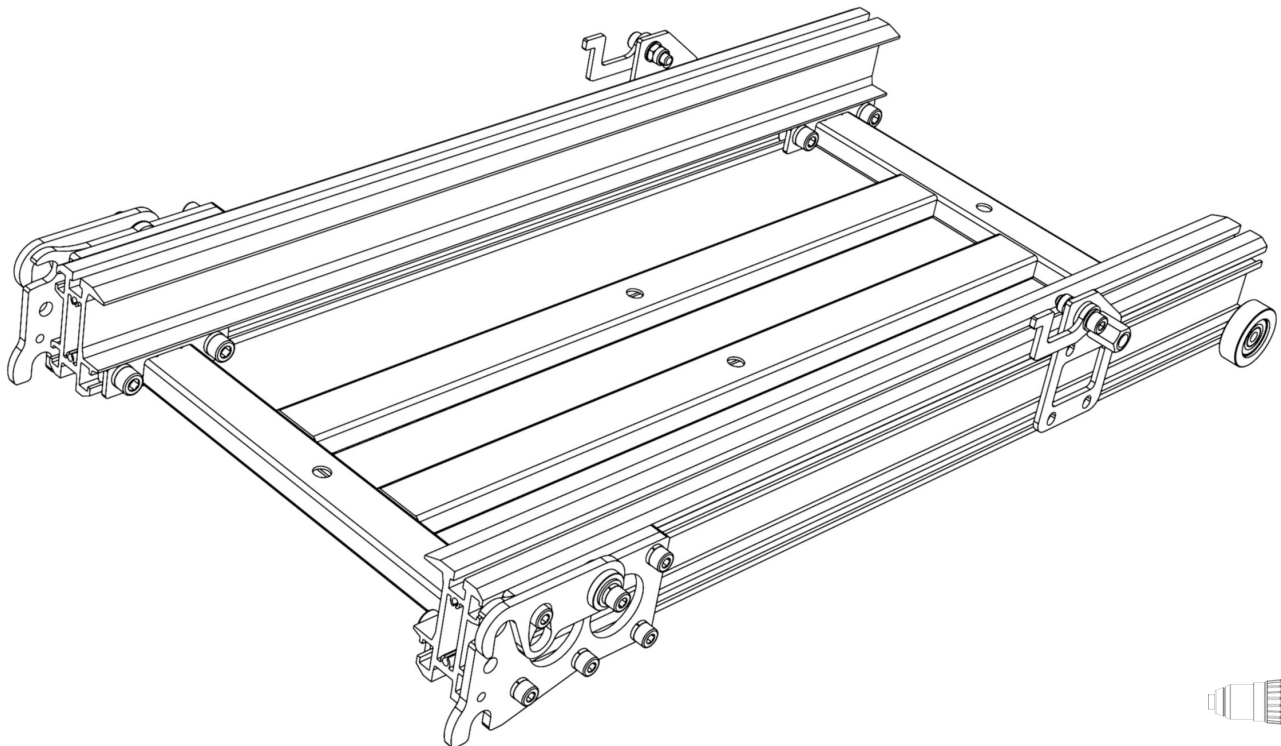

CORDLESS TOOL LIFT

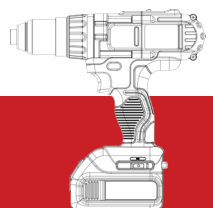

PARTS SUPPLIED WITH AC 001 KIT	3
DETACHING STOPPERS FROM MAIN FRAME	4
ATTACHING LOW PROFILE STOPPERS	5
ASSEMBLING AC 001 TO ITS FRAME	6
ATTACH RAMP SIDE BRACKETS	7
ADJUST RAMP SIDE BRACKETS	8
ATTACH EXTENDER BRACKETS	9

PARTS SUPPLIED WITH THE AC 001 KIT

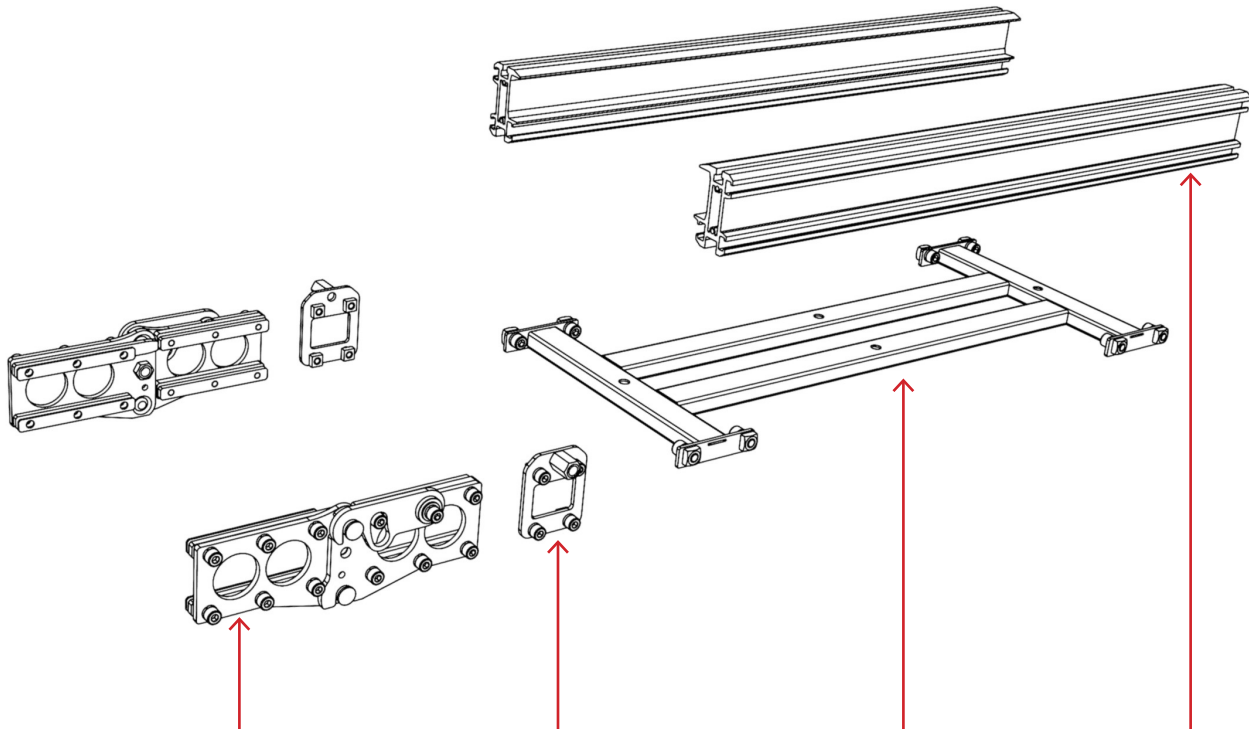

Lock and stopper assembly

Low profile locks

Base frame

Rails

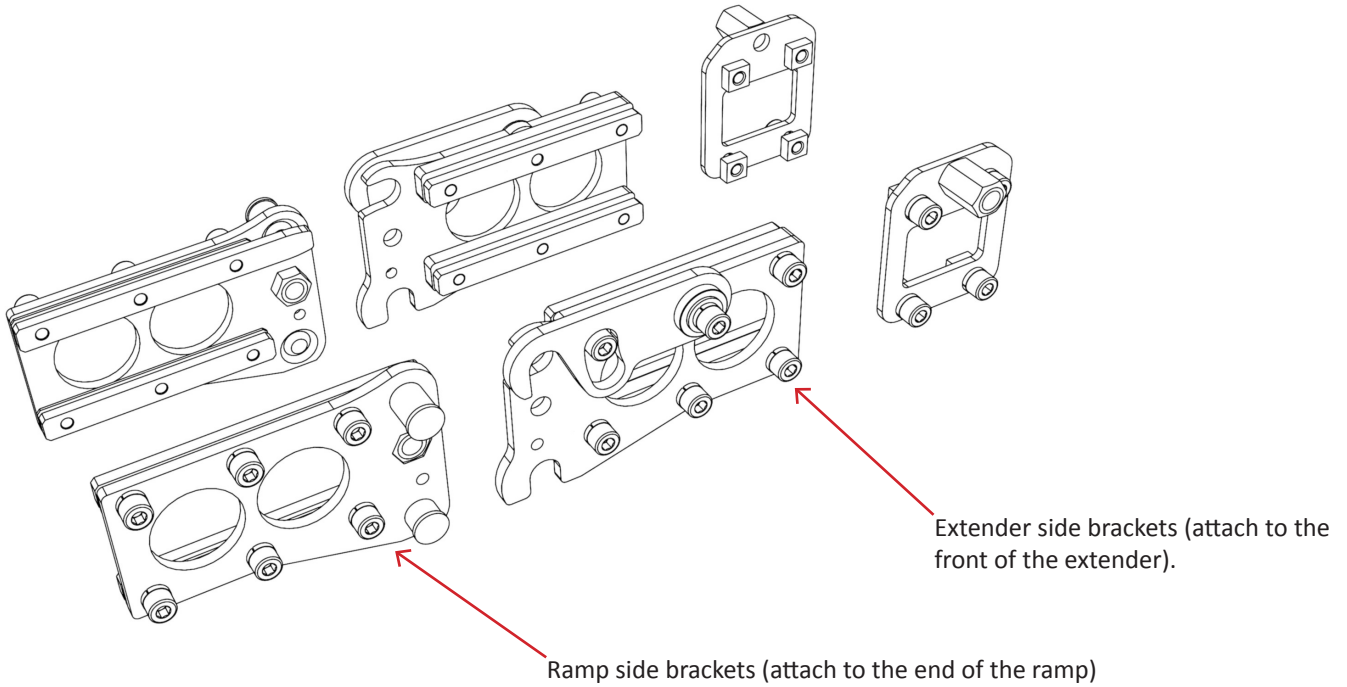

Extender side brackets (attach to the front of the extender).

Ramp side brackets (attach to the end of the ramp)

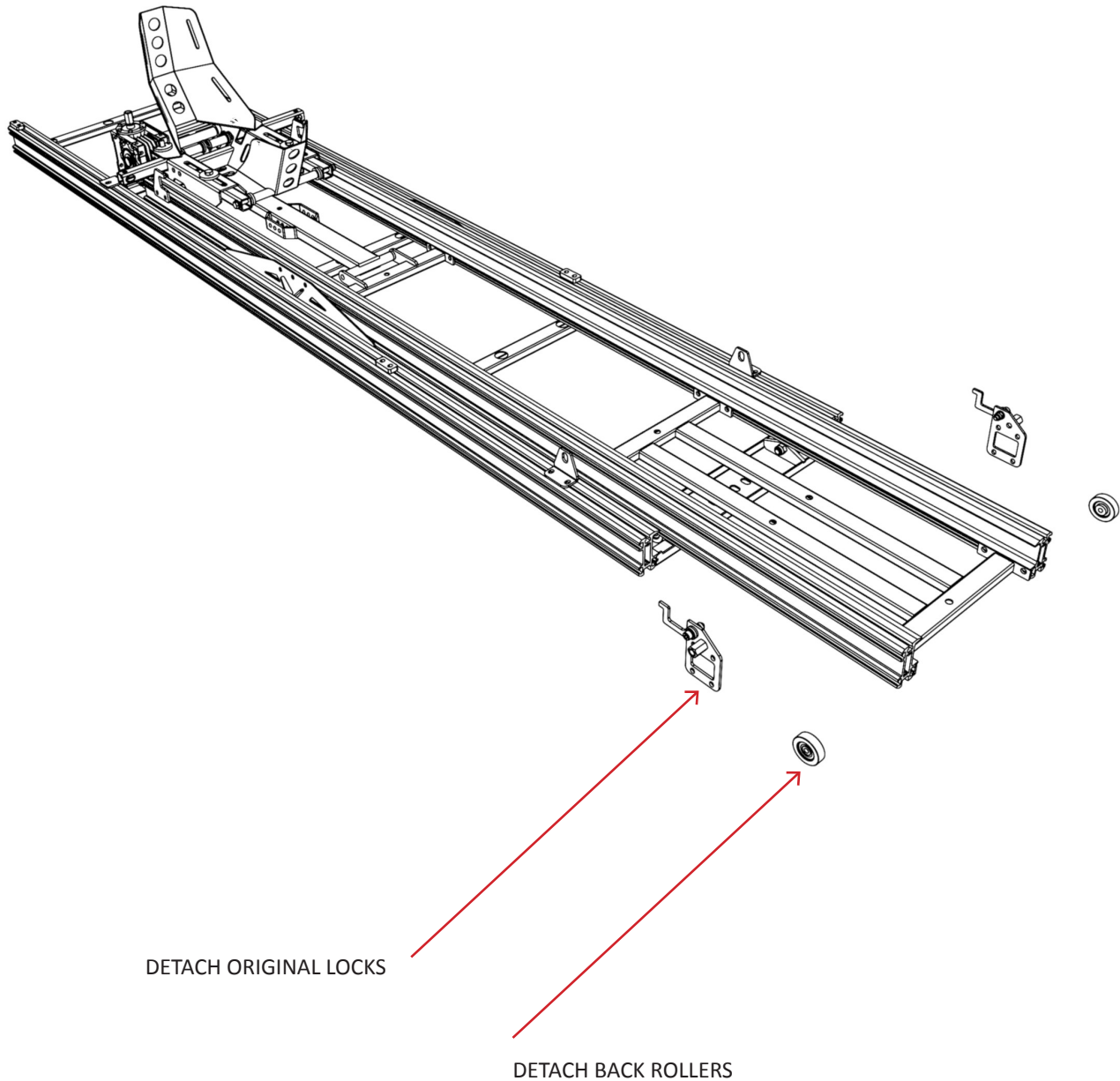

NOTES

Use a piece of tape to mark the position of the locks. Unscrew the lock knobs and slide the ramp out so you can reach the bolts holding the locks and the back roller. Loosen the bolts so that you can slide these parts out with the nuts still attached.

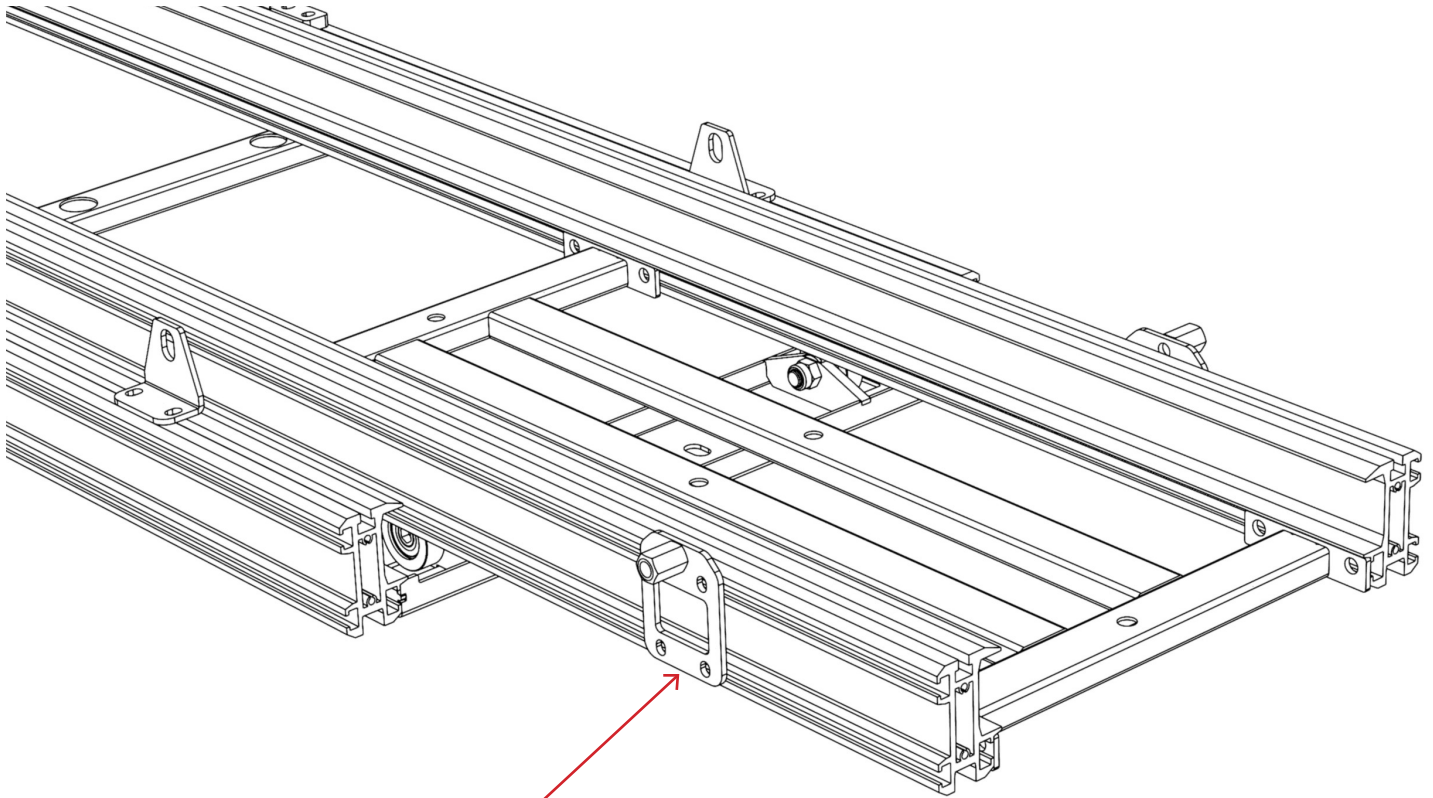

ATTACH LOW PROFILE LOCKS

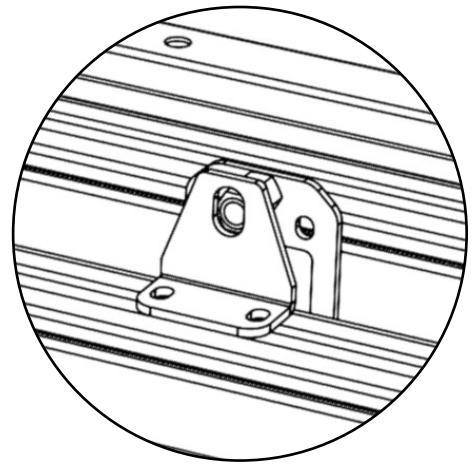

NOTES

Attach the low profile locks provided with the AC 001 kit where the old locks used to be. Retract the ramp until it stops and make sure the newly installed locks line up with the stopper

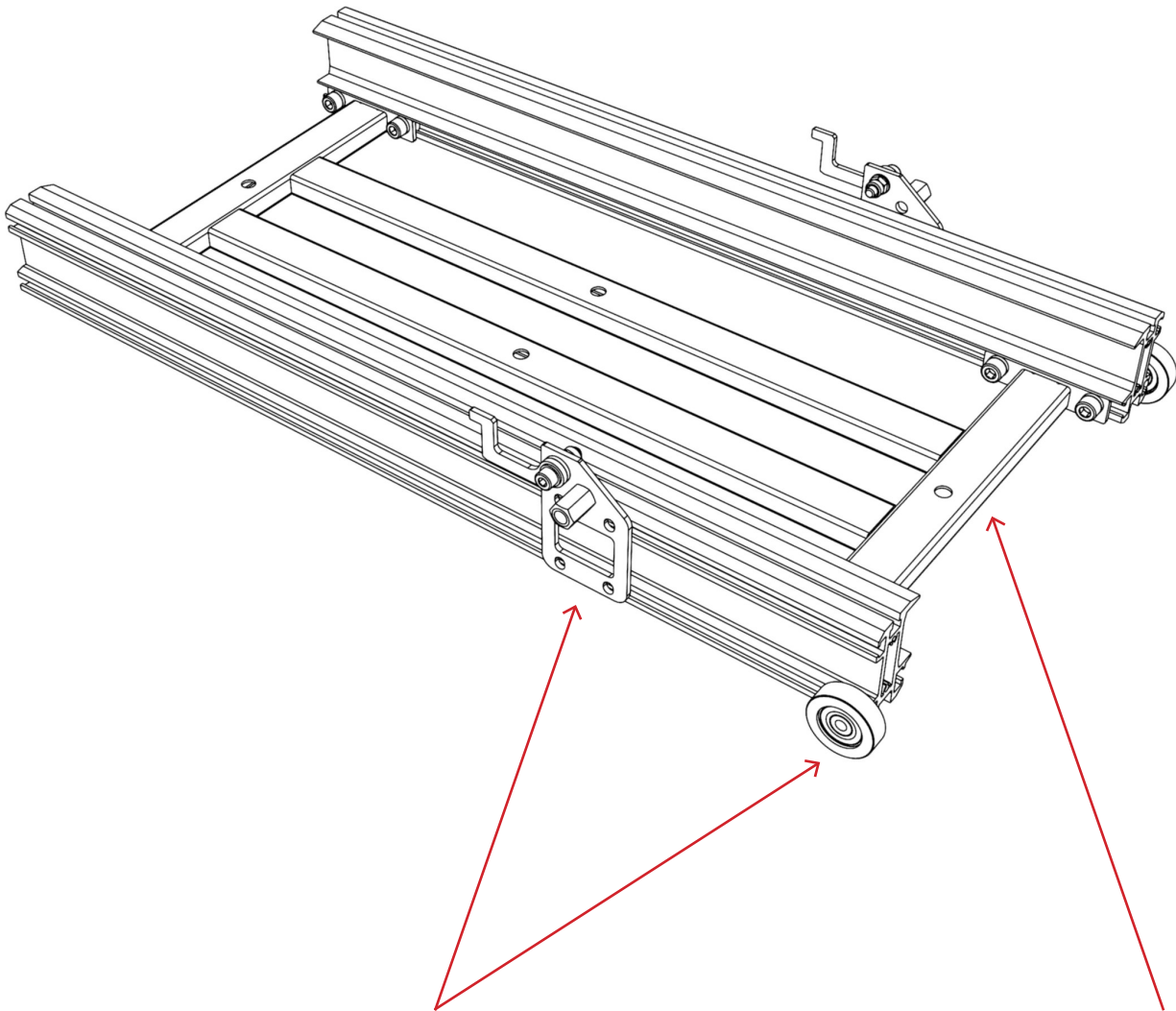

ATTACH LOCK BODY AND ROLLERS

STEEL FRAME

NOTES

Use the lock bodies from the ramp and attach them to the extender. Use the bolts provided with the steel frame to attach it to the aluminium rails. Please check the tech specs at the back of this manual to see the correct spacing and to check the sizes.

ATTACHING RAMP SIDE BRACKETS

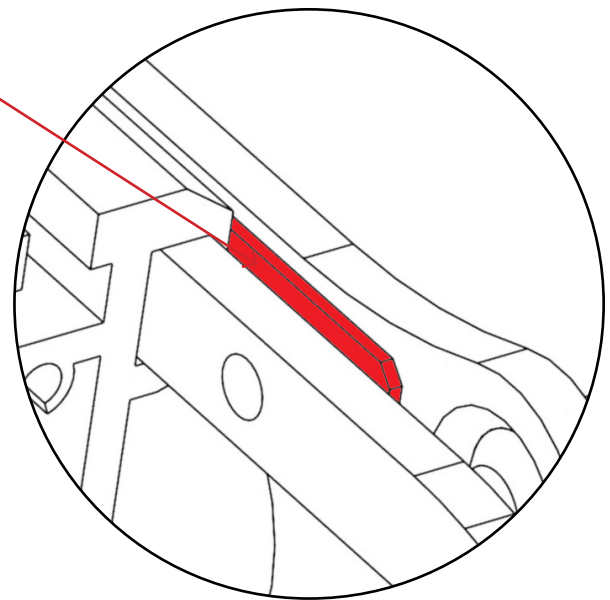
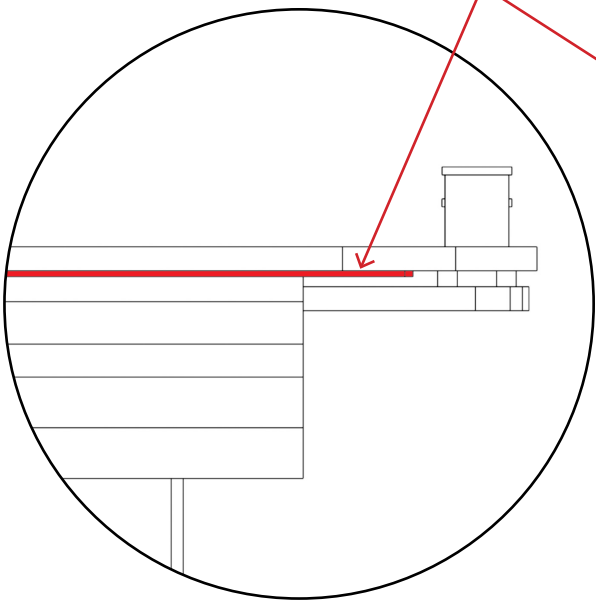
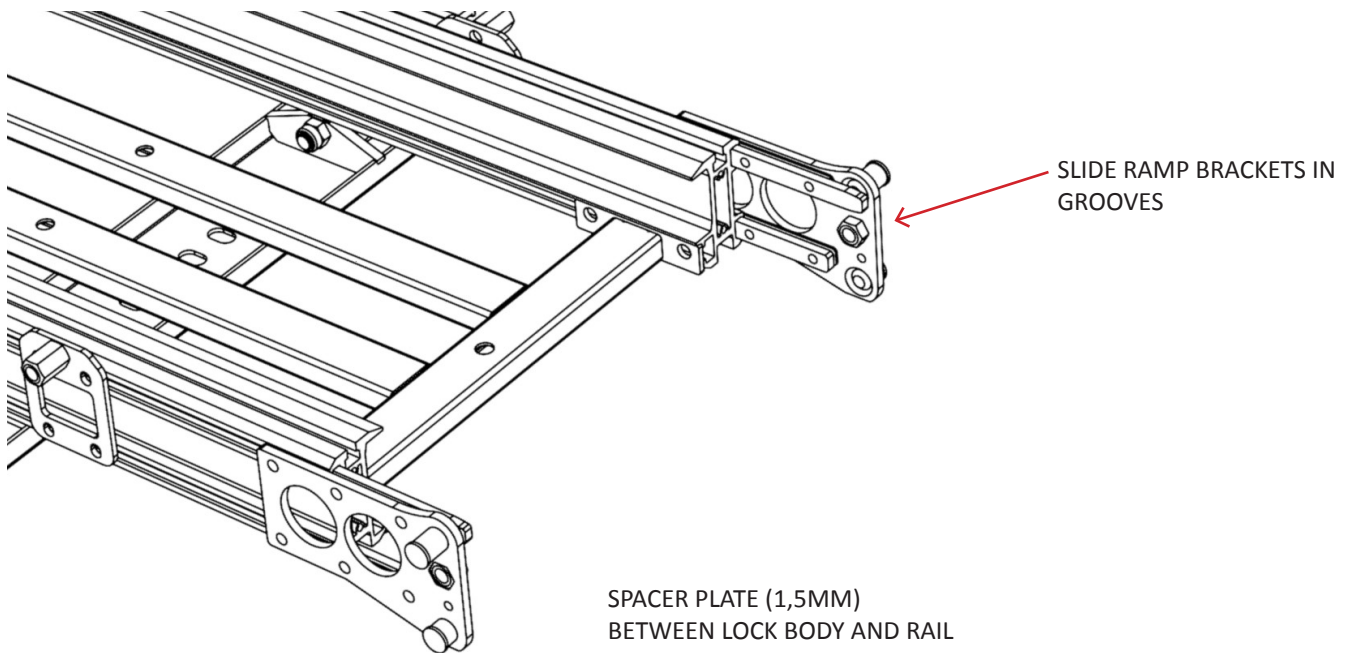

NOTES

Loosen the ramp side brackets bolts a little, just so you can slide the brackets through the ramp grooves. Please note that the thin spacer plate needs to sit between the lock body and the aluminium beam. You might want to use a mallet or other softer objects (piece of wood) to gently knock these in, as they are design to just fit in there.

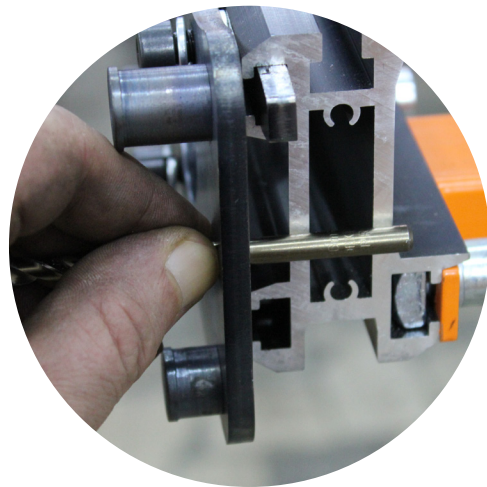
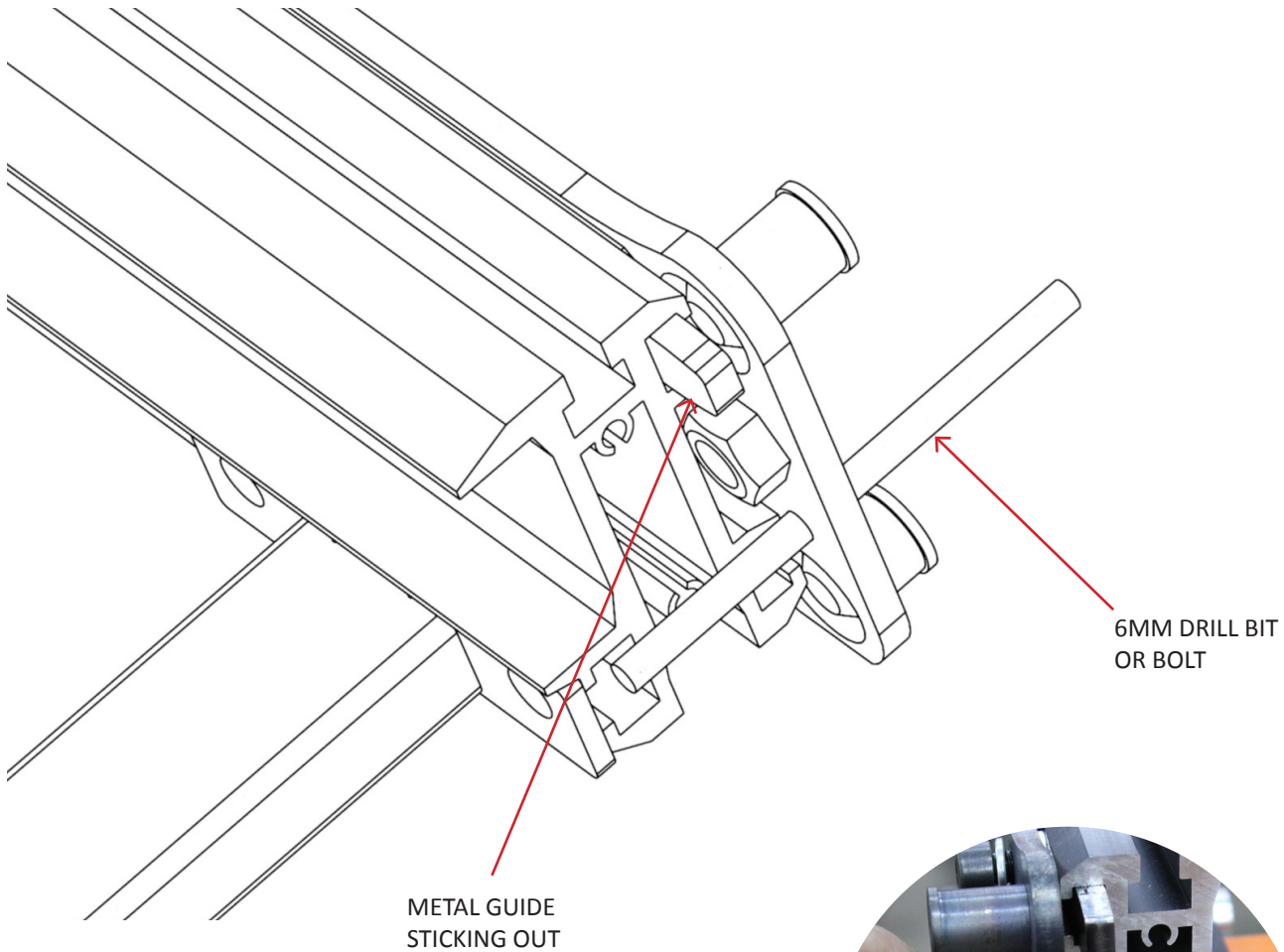

NOTES

Get a 6mm drill bit, or a 6mm bolt, and insert it through the 6mm hole provided in the bracket. Tap or slide the bracket into the rail until the drill bit touches the rail face. Tighten the bolts, and repeat the procedure for the other side. Please note that there is a metal guide plate sticking out from the alloy rail, this is normal. It needs to stick out so that it can guide the AC 001 into position when using it.

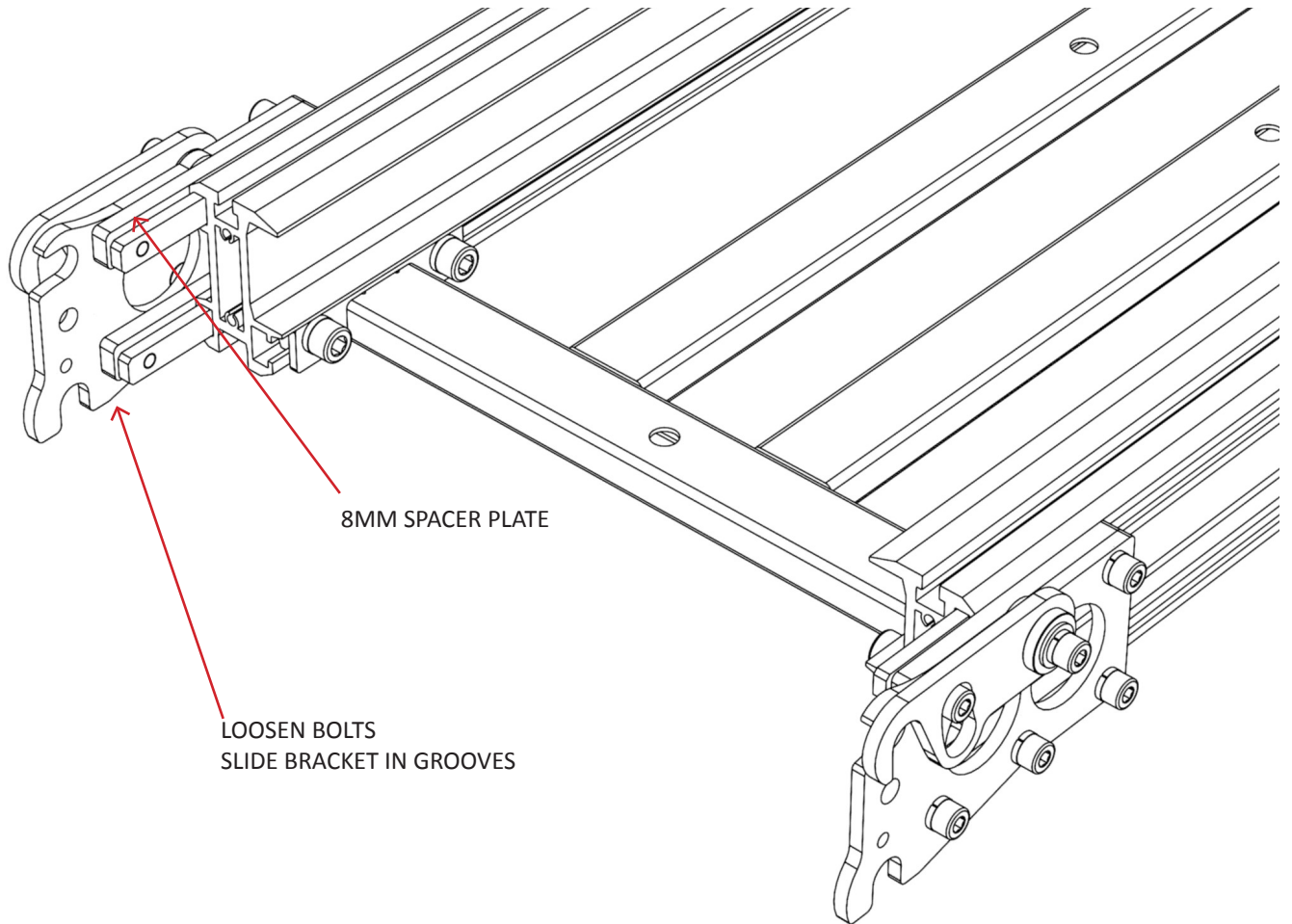

NOTES

Loosen these bolts too, and slide the brackets in the grooves. Use the same alignment method as for the ramp brackets, using a 6mm drill bit. Please note that the 8mm thick spacer plate needs to sit between the alloy rails and the lock body.

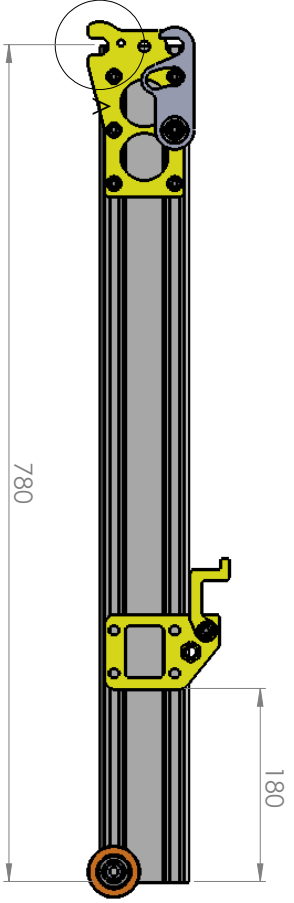
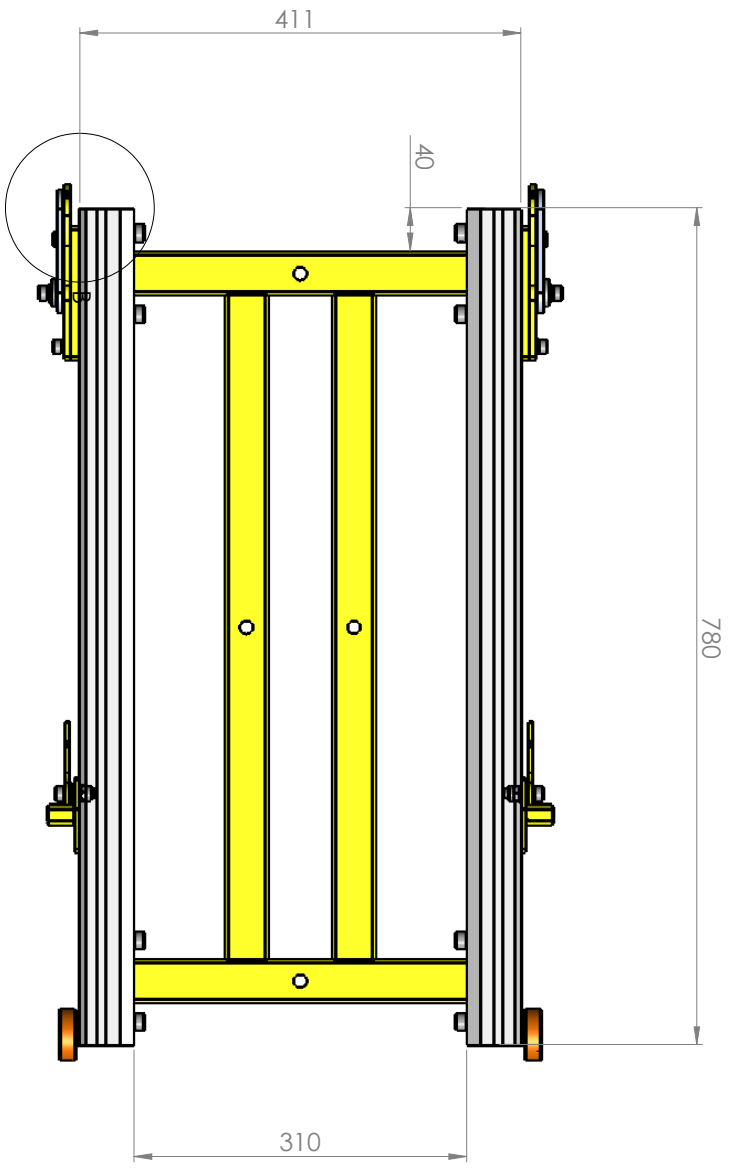

DETAIL A
SCALE 1 : 2

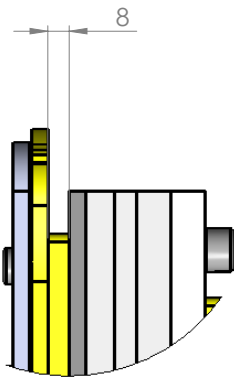
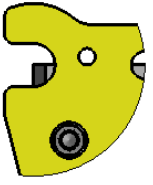

DETAIL B
SCALE 1 : 2

